

**PART NUMBER****PFF60-902****DESCRIPTION****FRONT ARM REAR BUSH****INSTALLATION GUIDE****Contents (parts per pack):**

- | | |
|----------------------------|------------------------------------|
| 2 x Polyurethane Bushes | 2 x Plated Mild Steel Outer Sleeve |
| 2 x Stainless Steel Sleeve | 4 x Plated Mild Steel Washers |
| 1 x PTFE/Silicone Grease | |

Please read the complete fitting instructions and check package components before fitment. These fitting instructions are to be used as a guide and in conjunction with workshop manual.

It is recommended that:

- all work to be carried out by a licensed technician;
- all safety precautions adhered to;
- wheel alignment to be checked and adjusted as required after any suspension work.
- All fasteners must be tensioned to manufacturer's torque settings.

**Fitting Instructions:**

1. Remove the original rubber bush from the arm, clean any dirt and corrosion from the bore in the arm.
2. Press the outer shell into the arm from the top side of the arm until the larger diameter of the shell is against the arm.
3. Press the polyurethane bush into the top of the outer shell.
4. Apply some washing up liquid to the bore of the shells and press the polyurethane bush in until fully through the arm.

Tip: If you are having trouble pressing the bush in, try pressing the bush in at a slight angle so that one part of the lip is already in the bore of the shell; when steady pressure is applied, the rest of the lip should follow.

5. Apply the provided grease to the bore and mounting faces of the bush that come into contact with the washers.
6. Fit the Stainless Steel sleeve into the bushes.
7. Ensure that the washers are fitted and correctly seated on the outside face of each bush prior to final torquing of any fixings, as shown in figure 1.
8. Torque all hardware to manufacturers recommended torque settings.

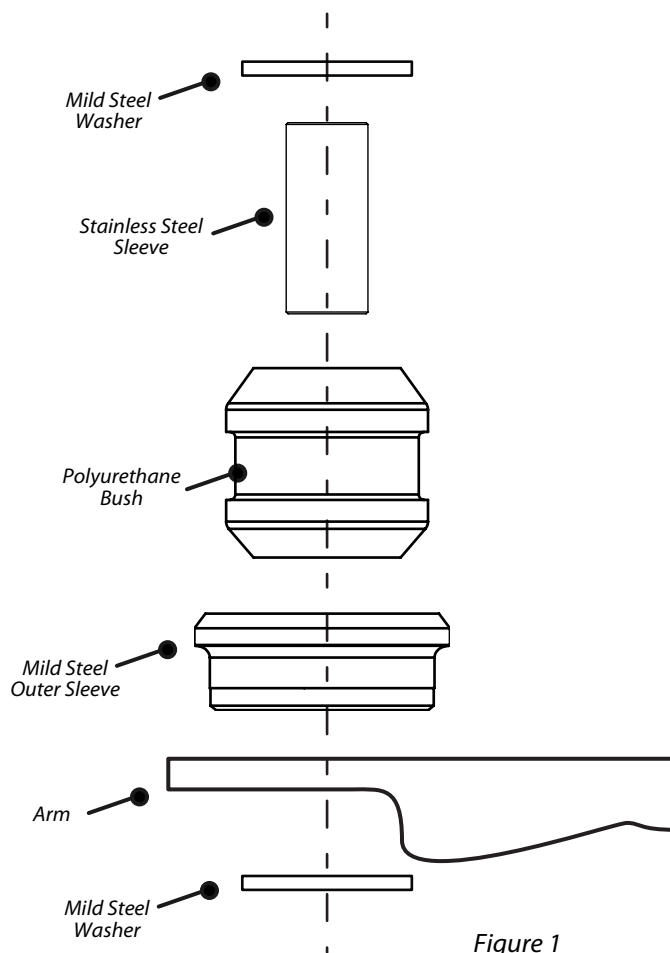

Figure 1